

# User Guide

## 2 Stage 4 RedLine

### EVO Slim

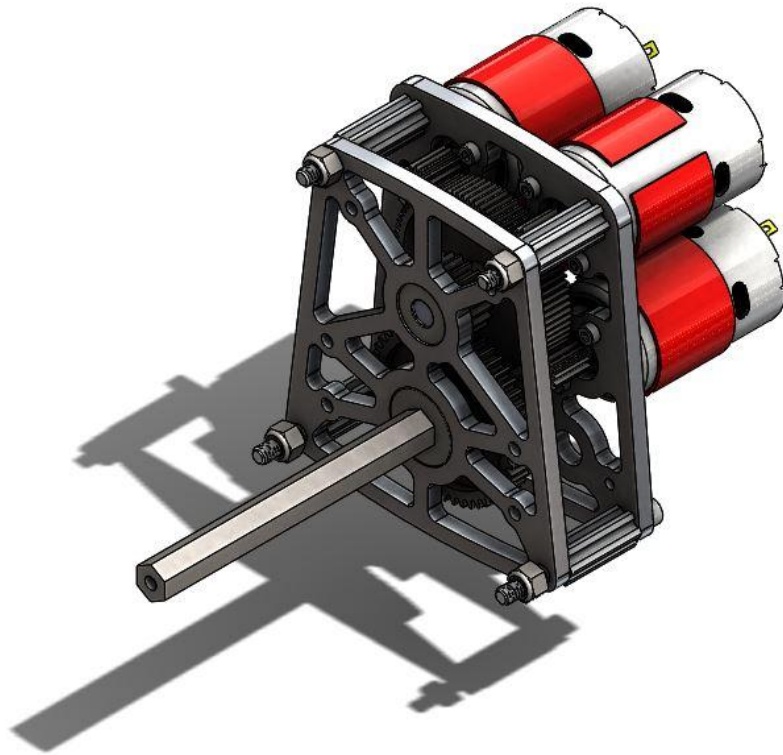

Part Number	Description	Quantity
am-0801a	Long Hex Output Shaft w/ Ring & Magnet	1
am-3823	EVO Slim 2 Stage Motor Plate	1
am-3488	50T 20DP .500 Hex Gear	1
am-3814	Cluster Shaft for 2 Stage EVO Slim	1
am-3813	Churro Spacer	4
am-0028	3/8" Flanged Shielded Bearing (FR6ZZ)	2
am-0573	3/8"ID 1-1/8" OD Bearing (FR6ZZ-L)	1
am-2986	1/2" Hex Bearing (FR8ZZ-HexHD)	1
am-3820	20T 20DP .375 Hex Gear	1
am-1364	1/16" Long 1/2" Hex Acetal Spacer	1
am-1264	SHCS M4-0.7 x 10mm	8
am-1031	SHCS 1/4-20 x 2500	2
am-1447	FHCS 1/4-20 x 2.25"	2
am-1015	1/4-20 Nylock Nut	4
am-3528	EVO 2 Stage Output Plate	1
am-3533	85T 32DP .375 Hex Gear	1
am-3657	12T 32DP Pinion Gear	4
am-3650	775 Vent Plate Spacer	4

Tools Needed	Part Number
Arbor Press	
7/16" Wrench	am-2745
3/16" Hex Driver	am-2752
5/32" Hex Driver	am-2751
2.5mm Allen Wrench	am-1288

## **EVO Slim with 17.71:1 Shown (am-3806 177)**

**Step 1:** Carefully press the 12T Pinion Gear (am-3657) onto the RedLine Motor (am-3775). Be sure to leave a small (~1/32" or 1mm) gap between the

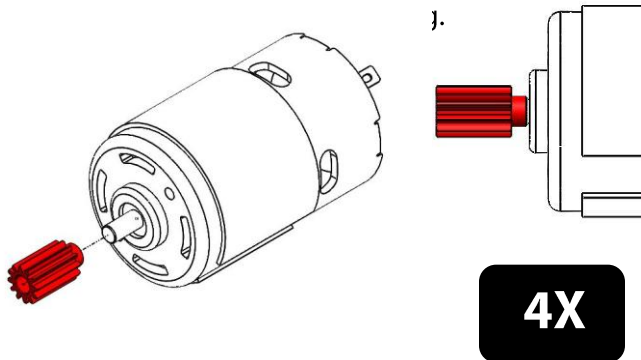

**Step 2:** Press FR6ZZ bearing (am-0028) into the top hole of the EVO Slim 2 Stage Motor Plate (am-3823)

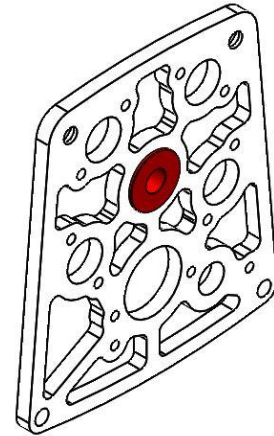

**Step 3:** Press FR6ZZ-L bearing (am-0573) into the bottom hole of the EVO Slim 2 Stage Motor Plate.

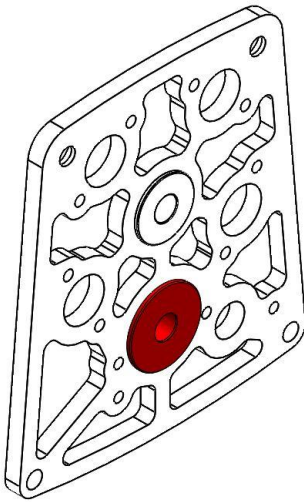

**Step 4:** Place 775 Vent Plate Spacer (am-3650) on two of the RedLine Motors

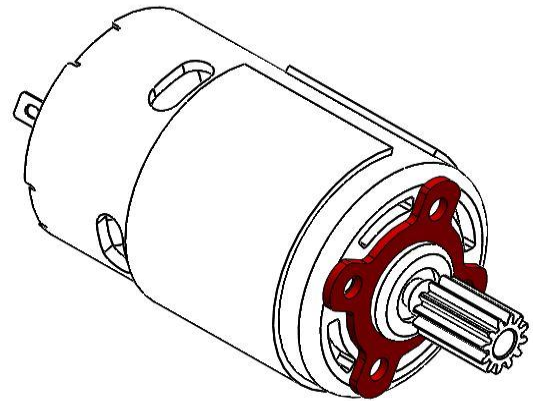

**Step 5:** Insert two of the RedLine motors to the EVO Slim 2 Stage Motor Plate. Only put in the bottom two motors. The motors go on the opposite side of the bearing flange

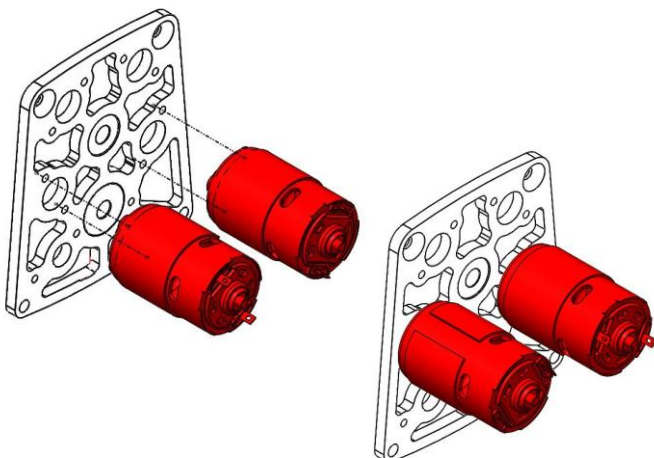

**Step 6:** Mount the two motors with four M4-0.7 x 10mm Screws (am-1264).

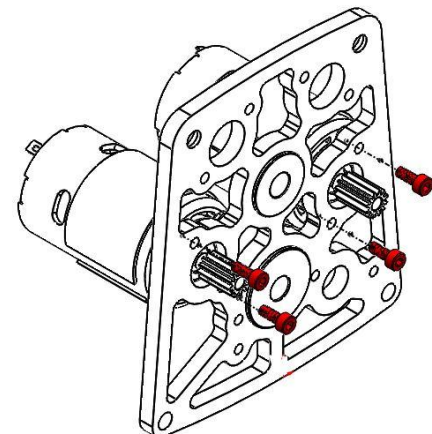

**Step 7:** Place Cluster Shaft for 2 Stage EVO Slim (am-3814) into the FR6ZZ bearing.

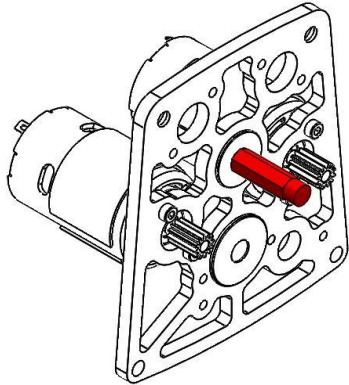

**Step 8:** Slide 85T gear (am-3533) onto the cluster shaft. The 85T gear and the two pinion gears will mesh.

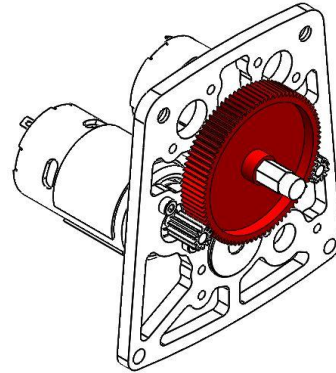

**Step 9:** Slide 20T gear (am-3820) onto the cluster shaft.

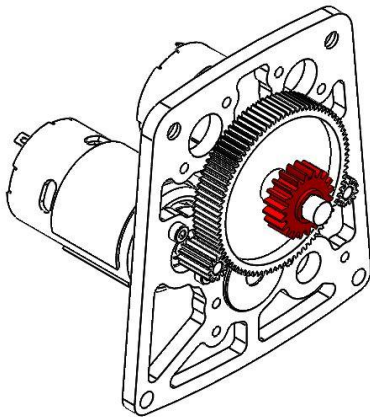

**Step 10:** Place Long Hex Output Shaft (am-0801a\_ring) into FR6ZZ-L bearing.

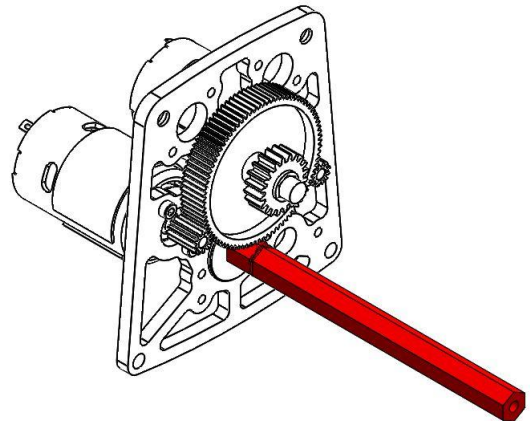

**Step 11:** Slide Acetal Hex Spacer (am-1364) onto Long Hex Output Shaft.

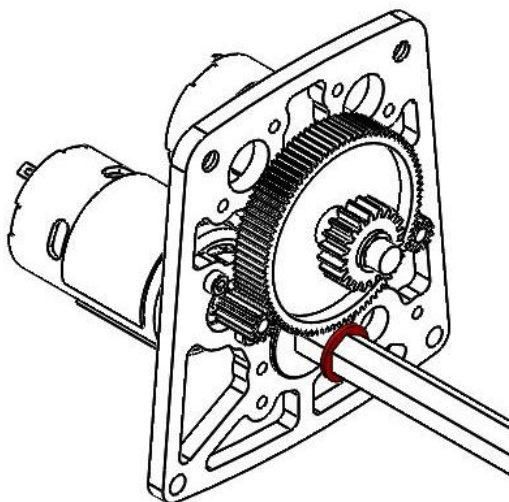

**Step 12:** Slide 50T gear (am-3488) onto Long Hex Output Shaft.

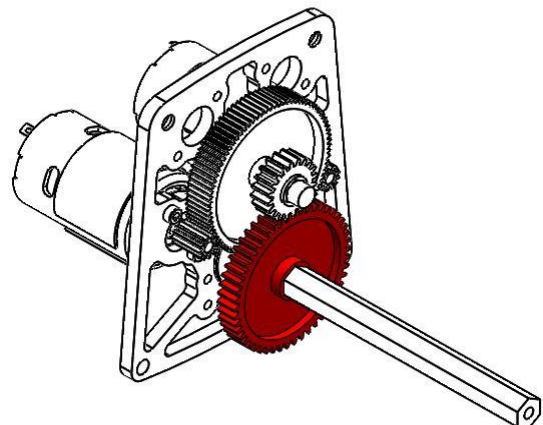



**Step 13:** Press the FR6ZZ Bearing (am-0028) into the top hole of the EVO 2 Stage Output Plate (am-3528)

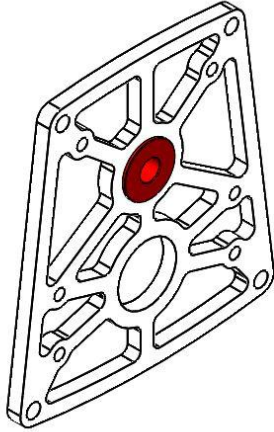

**Step 15:** Slide the output plate over the hex shaft. Bearings faced toward the gears. Press all the way until both shafts are seated into the bearings

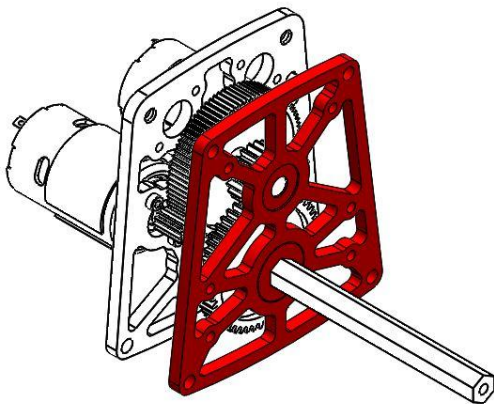

**Step 17:** Thread FHCS 1/4-20 x 2.25" (am-1031) in through the output plate, Churro Spacer (am-3813) then the motor plate

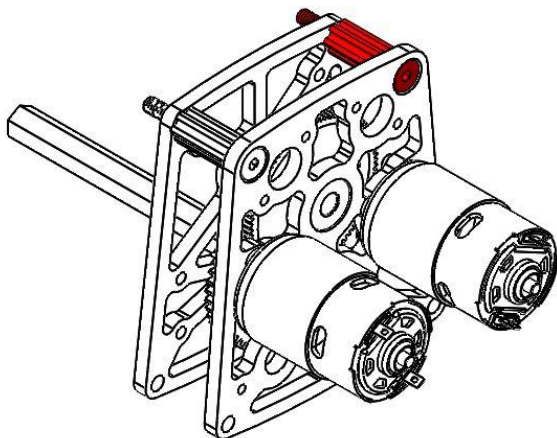

**Step 14:** Press the FR8ZZ-Hex Bearing (am-2986) into the bottom hole of the EVO 2 Stage Output Plate

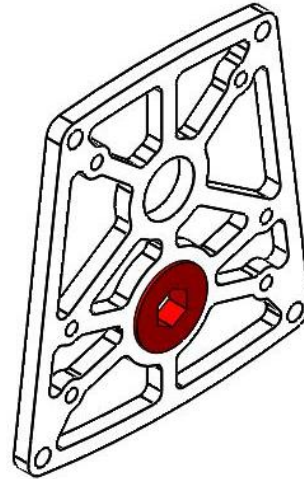

**Step 16:** Thread FHCS 1/4-20 x 2.25" (am-1031) in through the output plate, Churro Spacer (am-3813) then the motor plate

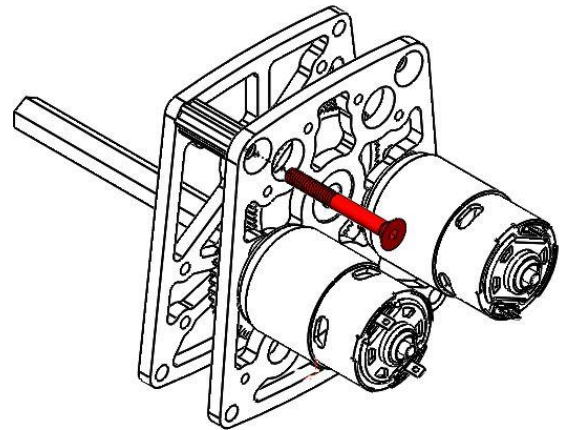

**Step 18:** Tighten the screws with 1/4-20 Nylock Nut (am1015)

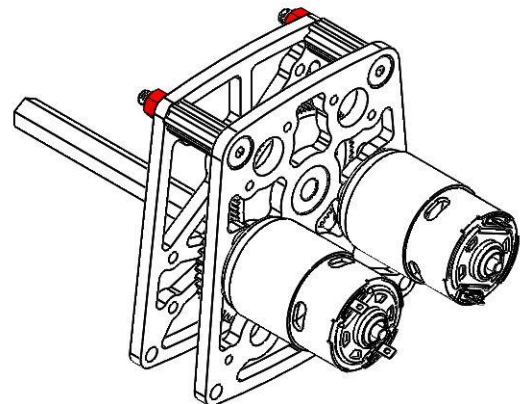

**Step 19:** Thread two SHCS ¼-20 x 2500 (am-1031) in through the output plate, Churro Spacer (am-3813) then the motor plate

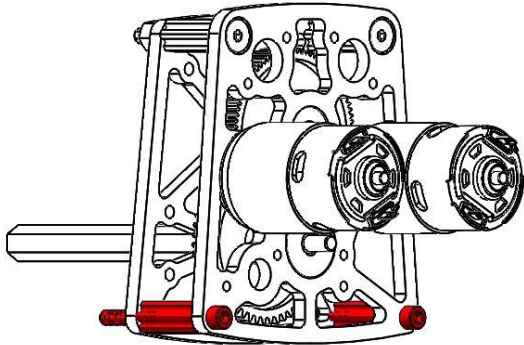

**Step 20:** Tighten the screws with ¼-20 Nylock Nut (am-1015)

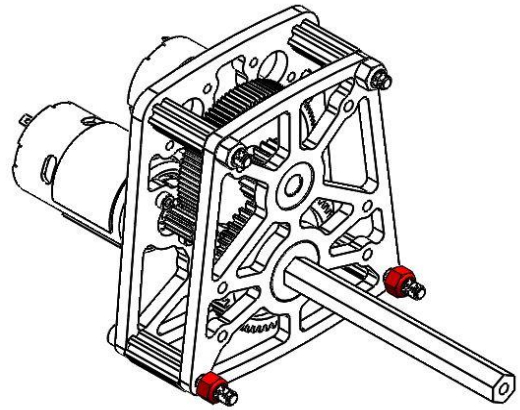

**Step 21:** Place 775 Vent Plate Spacer (am-3650) on two of the RedLine Motors

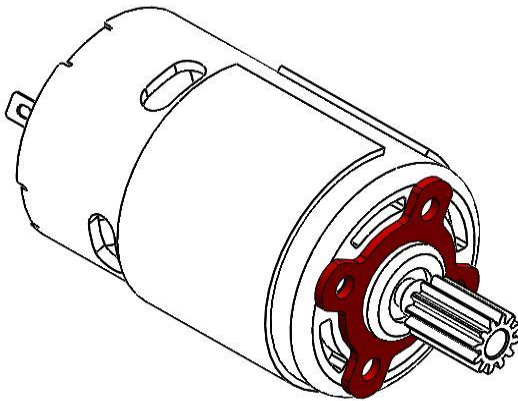

**Step 22:** Insert two of the RedLine motors in the top two holes of the EVO Slim 2 Stage Motor Plate. The 85T gear and the two pinion gears will mesh

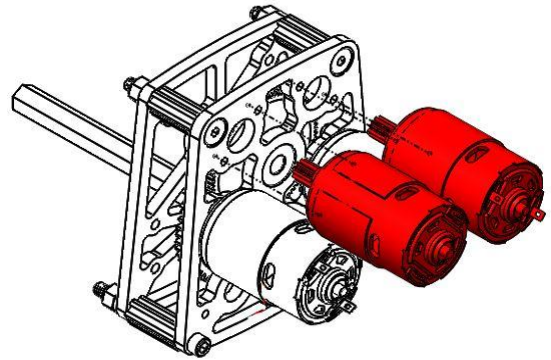

**Step 23:** Insert four SHCS M4-0.7 x 10mm (am-1264) into the mounting holes. Tighten screws by putting allen wrench through the gearbox

