

REVISION HISTORY			
REV.	DESCRIPTION	DATE	DRAWN BY
1	ORIGINAL PRINT	10/17/2018	N.MASSOUDA

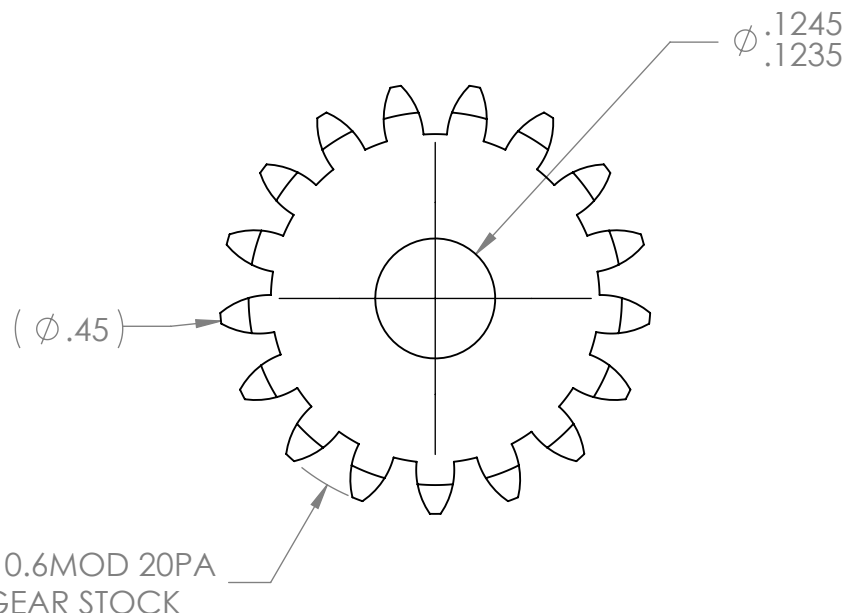

17T 0.6MOD 20PA GEAR STOCK

*** SEE CAD FOR ADDITIONAL TOOLPATH INFO***

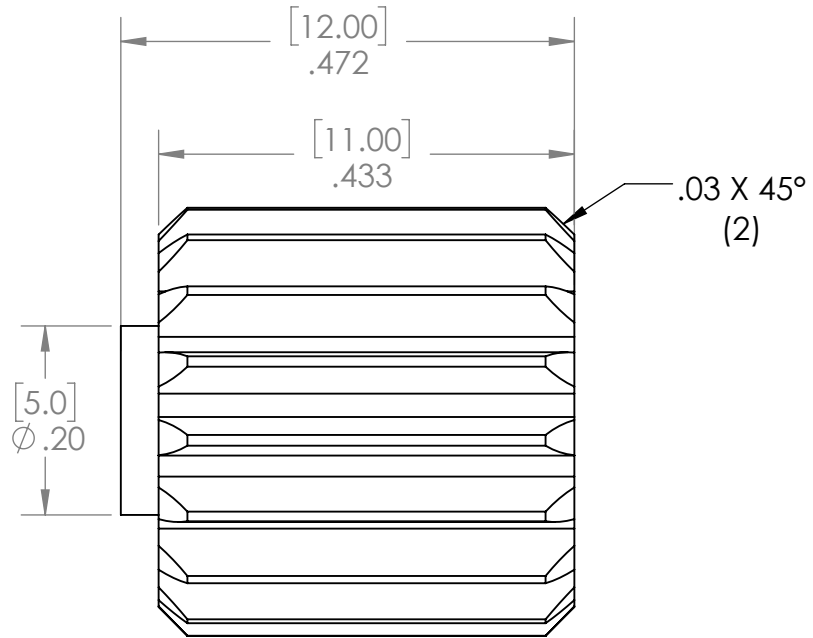
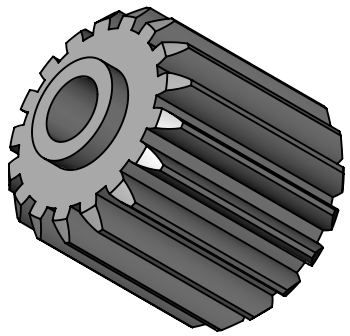

UNLESS OTHERWISE SPECIFIED:		COMMENTS:			
DIMENSIONS ARE IN INCHES		DUAL DIMENSIONS ARE IN MILLIMETERS.			
TOLERANCES:		BREAK ALL SHARP EDGES		TITLE:	
FRACTIONAL	±1/16			17T 0.6MOD 20PA 0.125IN	
ANGULAR: MACH	±1°			ROUND BORE GEAR	
ANGULAR: BEND	±5°			SIZE	
ONE PLACE DECIMAL	±0.1			DWG. NO.	
TWO PLACE DECIMAL	±0.01			A am-2068a	
THREE PLACE DECIMAL	±0.005			REV	
FOUR PLACE DECIMAL	±0.0005			1	
MATERIAL	1215 STEEL	NAME	DATE	SCALE: 5:1	
FINISH	NONE	CHECKED		WEIGHT:	
		ENG APPR.		SHEET 1 OF 1	
		MFG APPR.			
DO NOT SCALE DRAWING		Q.A.			