

FIRST® Tech Challenge Field Perimeter (AM- 0481a) Setup Guide

2016 Revision

Components:

- 4 - Hinged Panel Corners
- 4 - Flat Panel Sections
- 4 - Strap Hooks
- 2 - Straps
- 16 - Panel Rail Links
- 32 - Panel Link Fastener Pins

Step 1: Take the panels that are attached at one end and unfold them to their stop at 90 degrees for the corner.

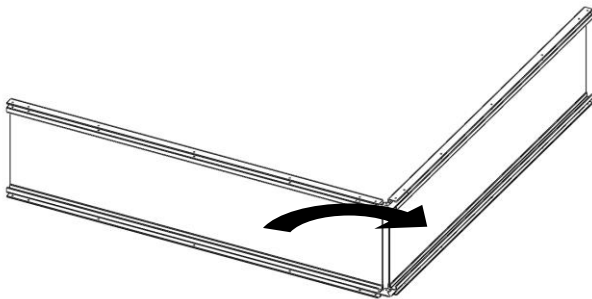

Step 2: At the end of each panel insert and align the rail link with the hole in the panel and insert the pin. Repeat this step for the bottom of the panel, but insert the pins from the inside with the ring side up.



Step 3: Take one of the single panels and attach it to the rail link by sliding it over the rail link and inserting the pin. When attaching make sure the panels are facing the same direction.

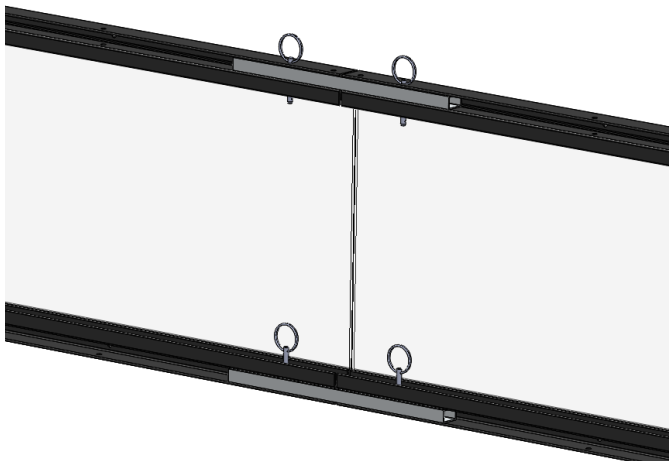

Step 4: Unfold another corner panel and attach it to the single panel in the same manner as before. Ensure the panels face the same direction and at this point it should be in the shape of a U.

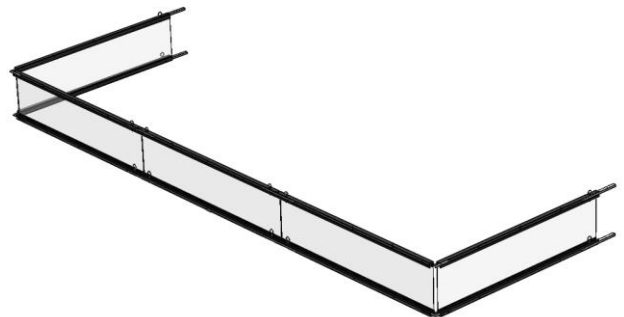

Step 5: Repeat the previous steps until the field is the shape of a square and resembles the picture below.

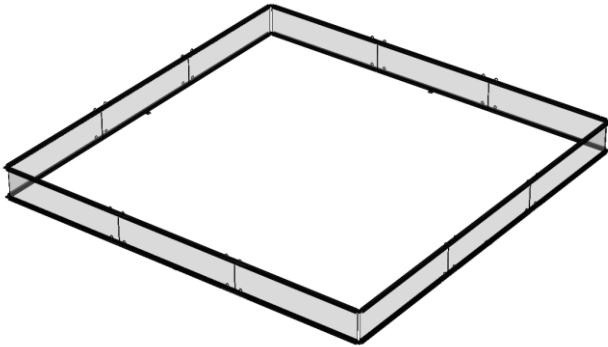

Step 6: Feed the strap through the clip and attach the clip to the bottom middle of the center panels on all four sides of the field.

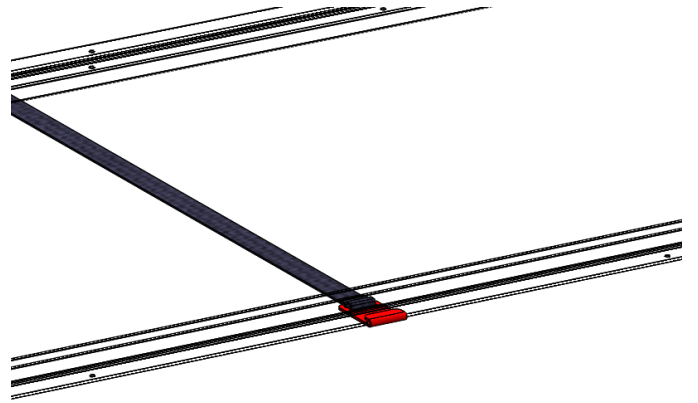

Step 7: Once the clips are attached to the panels pull the straps snug. Ensure that the field perimeter is square.

