

4

3

2

1

REVISION HISTORY			
REV.	DESCRIPTION	DATE	DRAWN BY
1	ORIGINAL PRINT	12/18/2019	N. LAWRENCE

B

B

A

A

QTY 1 6IN PNEUMATIC TIRE
(am-2474)

QTY 1 6IN PNEUMATIC INNER TUBE
(am-2475)

QTY 1 6IN PNEUMATIC HUB ASSEMBLY
(am-2469)

QTY 1 250 SPROCKET AND PULLEY SPACER
(am-0207a)

QTY 1 42T HTD PULLEY EXTENSION
(am-2813)

QTY 1 42T HD PULLEY
(am-2234)

QTY 6 10-32 x 3.5" SHCS
(am-1402)

QTY 1 R8ZZ BEARING
(am-0181)

QTY 1 SHOULDER SPACER
(am-1519)
[PRESSED INTO BEARING]

QTY 6 10-32 NYLOCK JAM NUT
(am-1063)

QTY 1 1614ZZ BEARING
(am-0209)

QTY 1 3/8 HEX x 0.250 SPACER
(am-3947-250)

QTY 1 3/8 HEX x 0.188 SPACER
(am-3947-188)

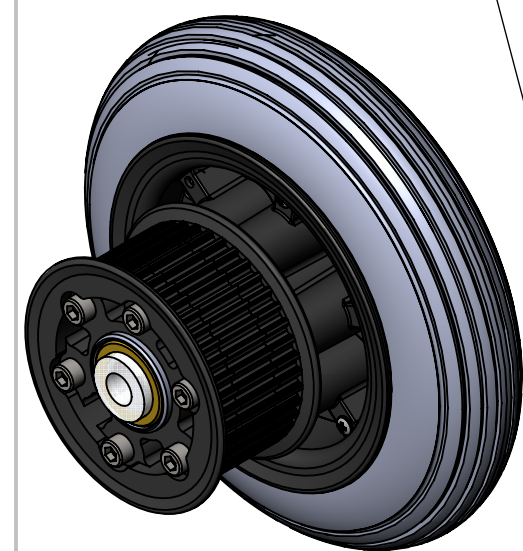

4

3

2

1

*** SEE CAD FOR ADDITIONAL TOOLPATH INFO***

UNLESS OTHERWISE SPECIFIED:		COMMENTS:				
DIMENSIONS ARE IN INCHES		DUAL DIMENSIONS ARE IN MILLIMETERS.				
TOLERANCES:		BREAK ALL SHARP EDGES.		AM14U4 PN6		
FRACTIONAL	±1/16			CORNER WHEEL ASSEMBLY		
ANGULAR: MACH	±1°			AND SPACER LAYOUT		
ANGULAR: BEND	±5°			SIZE	DWG. NO.	REV
ONE PLACE DECIMAL	±0.1			B	am-14U4_PN6	1
TWO PLACE DECIMAL	±0.01			SCALE: 1:4		
THREE PLACE DECIMAL	±0.005			SHEET 1 OF 3		
FOUR PLACE DECIMAL	±0.0005					
MATERIAL		CHECKED	NAME	DATE		
FINISH		ENG APPR.	KK	12/19/19		
		MFG APPR.				
		Q.A.				
DO NOT SCALE DRAWING						

4

3

2

1

REVISION HISTORY			
REV.	DESCRIPTION	DATE	DRAWN BY
1	ORIGINAL PRINT	12/18/2019	N. LAWRENCE

QTY 1 6IN PNEUMATIC INNER TUBE
(am-2475)

QTY 1 6IN PNEUMATIC TIRE
(am-2474)

QTY 1 6IN PNEUMATIC HUB ASSEMBLY
(am-2469)

QTY 1 42T HTD PULLEY EXTENSION
(am-2813)

QTY 1 42T HD PULLEY
(am-2234)

QTY 6 10-32 x 3.5" SHCS
(am-1402)

QTY 1 500EX HEX HUB
(am-2568)

QTY 1 500 HEX x 1.20" ALUMINUM SPACER
(am-3986-1200)

QTY 6 10-32 NYLOCK JAM NUT
(am-1063)

QTY 2 500 HEX x 1.00" SPACER
(am-3948-1000)

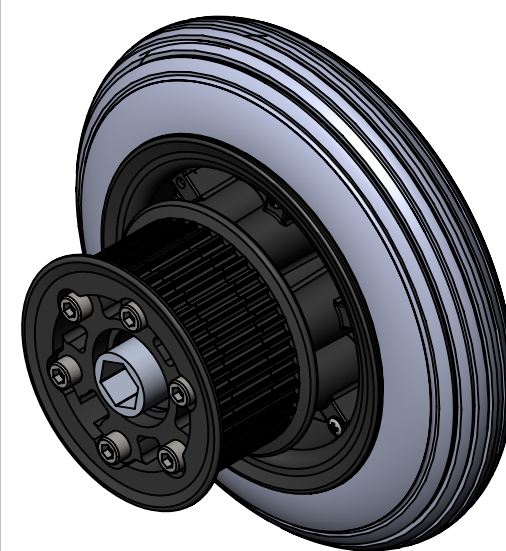
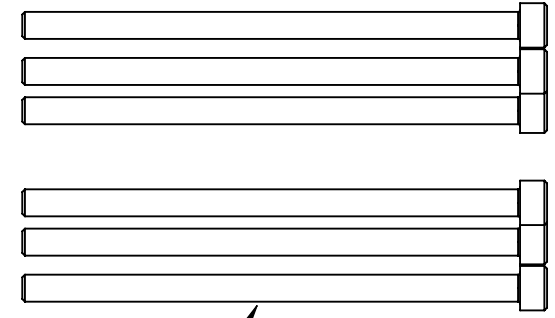
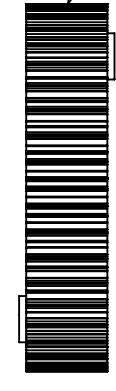
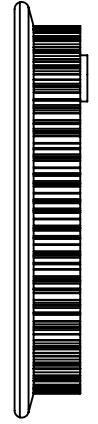
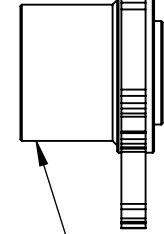
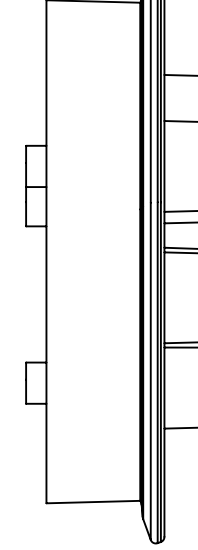
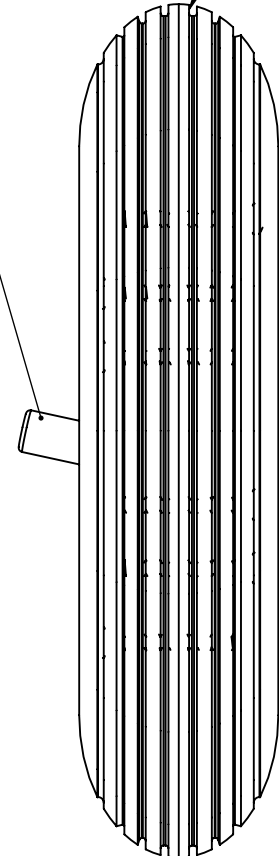
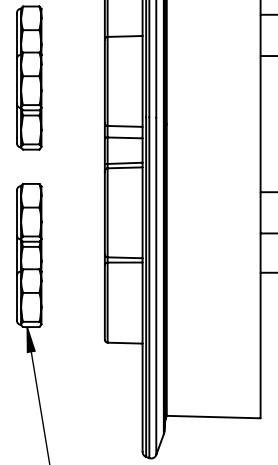

*** SEE CAD FOR ADDITIONAL TOOLPATH INFO***

UNLESS OTHERWISE SPECIFIED:		COMMENTS:		 TITLE: AM14U4 PN6 CENTRE WHEEL ASSEMBLY AND SPACER LAYOUT		
DIMENSIONS ARE IN INCHES		DUAL DIMENSIONS ARE IN MILLIMETERS.				
TOLERANCES:		BREAK ALL SHARP EDGES.		SIZE	DWG. NO.	REV
FRACTIONAL	±1/16			B	am-14U4_PN6	1
ANGULAR: MACH	±1°			SCALE:	SHEET 2 OF 3	
ANGULAR: BEND	±5°					
ONE PLACE DECIMAL	±0.1					
TWO PLACE DECIMAL	±0.01					
THREE PLACE DECIMAL	±0.005					
FOUR PLACE DECIMAL	±0.0005					
MATERIAL		CHECKED	NAME	DATE		
FINISH		ENG APPR.	KK	12/19/19		
		MFG APPR.				
		Q.A.				
DO NOT SCALE DRAWING						

4

3

2

1

4

3

2

1

REVISION HISTORY			
REV.	DESCRIPTION	DATE	DRAWN BY
1	ORIGINAL PRINT	12/18/2019	N. LAWRENCE

QTY 8 1/4-20 x 0.75 TFS
(am-1310)

QTY 2 3/8-16 NYLOCK NUT
(am-1054)

QTY 1 TOUGHBOX LONG SHAFT
(am-0801a)

QTY 2 755-5M-15 BELT
(am-3660)

QTY 2 CORNER WHEEL ASSEMBLY
(SEE PAGE 1)

QTY 1 CENTRE WHEEL ASSEMBLY
(SEE PAGE 2)

QTY 4 4.25" CHURRO
(CUT FROM am-3101-1)

QTY 1 500 HEXHD BEARING
(am-2986)

QTY 2 3/8-16 x 5.25 HEX BOLT
(am-1399)

*** SEE CAD FOR ADDITIONAL TOOLPATH INFO***

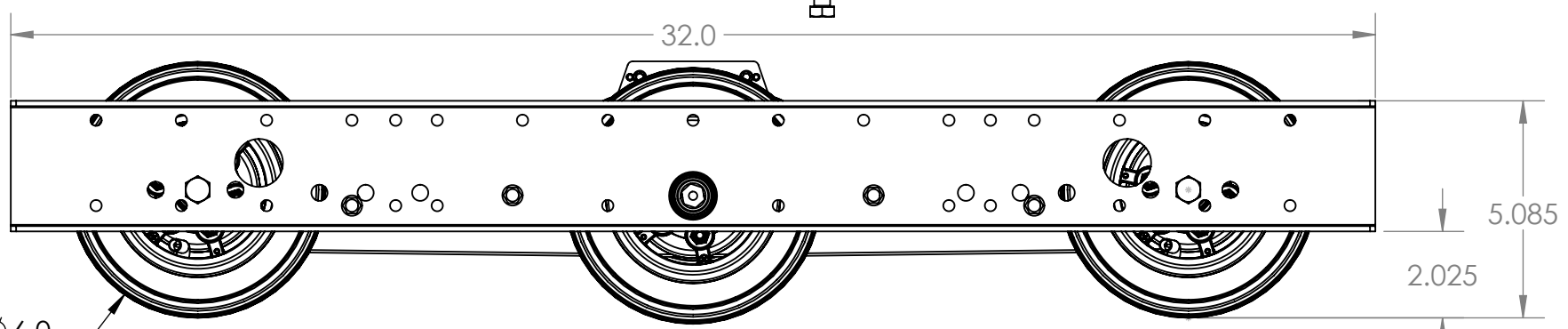

AXLE AND CHURRO LOCATIONS

UNLESS OTHERWISE SPECIFIED:

DIMENSIONS ARE IN INCHES

TOLERANCES:	
FRACTIONAL	±1/16
ANGULAR: MACH	±1°
ANGULAR: BEND	±5°
ONE PLACE DECIMAL	±0.1
TWO PLACE DECIMAL	±0.01
THREE PLACE DECIMAL	±0.005
FOUR PLACE DECIMAL	±0.0005
MATERIAL	
FINISH	
DO NOT SCALE DRAWING	

COMMENTS:

DUAL DIMENSIONS ARE IN MILLIMETERS.

BREAK ALL SHARP EDGES.

CHECKED	NAME	DATE
ENG APPR.	KK	12/19/19
MFG APPR.		
Q.A.		



TITLE:
**AM14U4 PN6
POWERTRAIN LAYOUT**

SIZE	DWG. NO.	REV
B	am-14U4_PN6	1
SCALE:	SHEET 3 OF 3	

4

3

2

1

B

B

A

A