

4

3

2

1

WHEN (+) VOLTAGE AT RED WIRE

CW

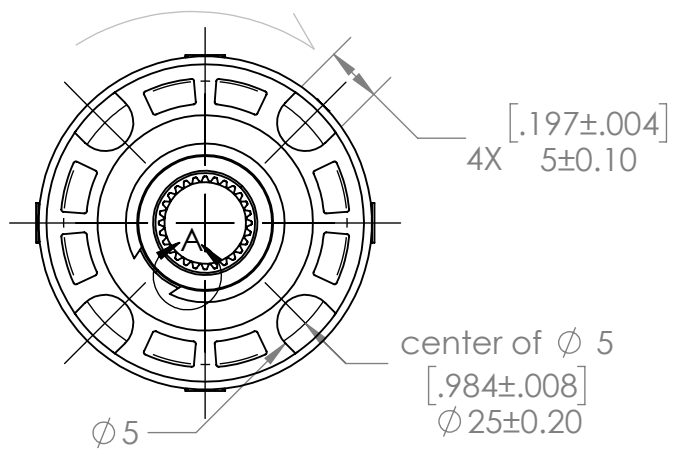

center of Ø 5  
[.984±.008]  
Ø 25±0.20

Ø7.18 TO Ø7.27

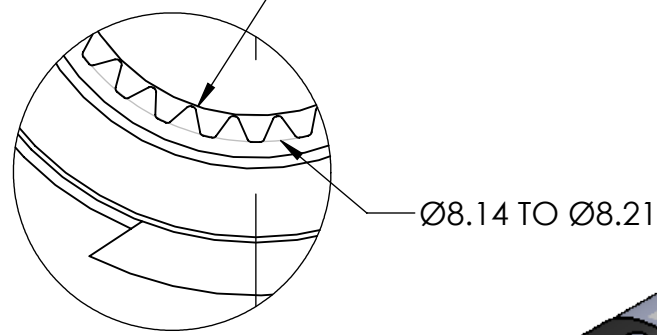

DIN 5481-7x8(z=28)  
DETAIL A  
SCALE 7 : 1

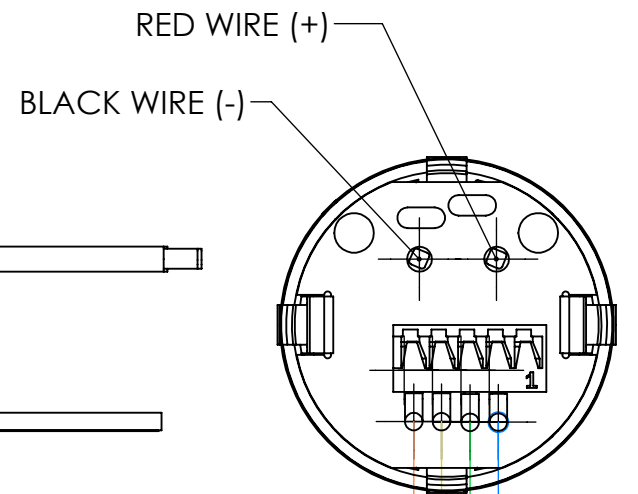
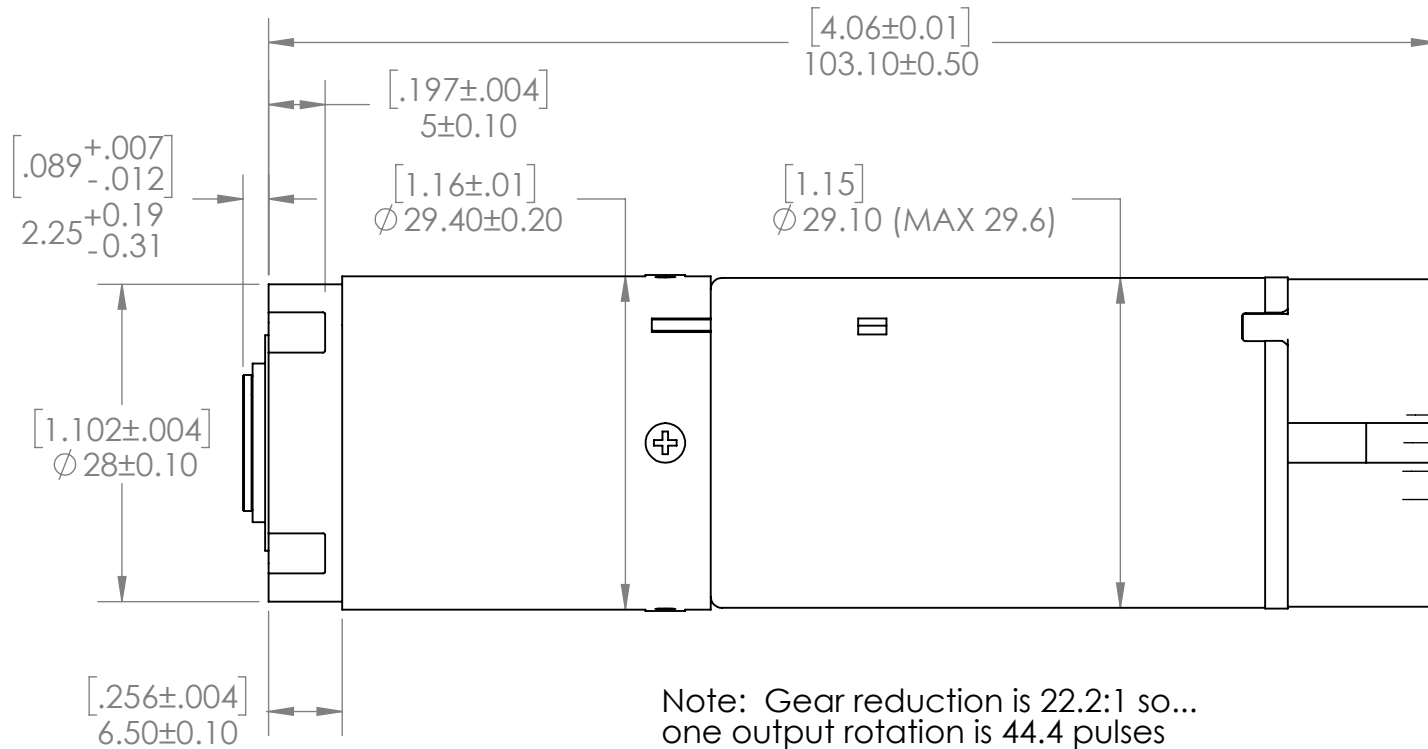

Note: Gear reduction is 22.2:1 so...  
one output rotation is 44.4 pulses

ONE MOTOR ROTATION

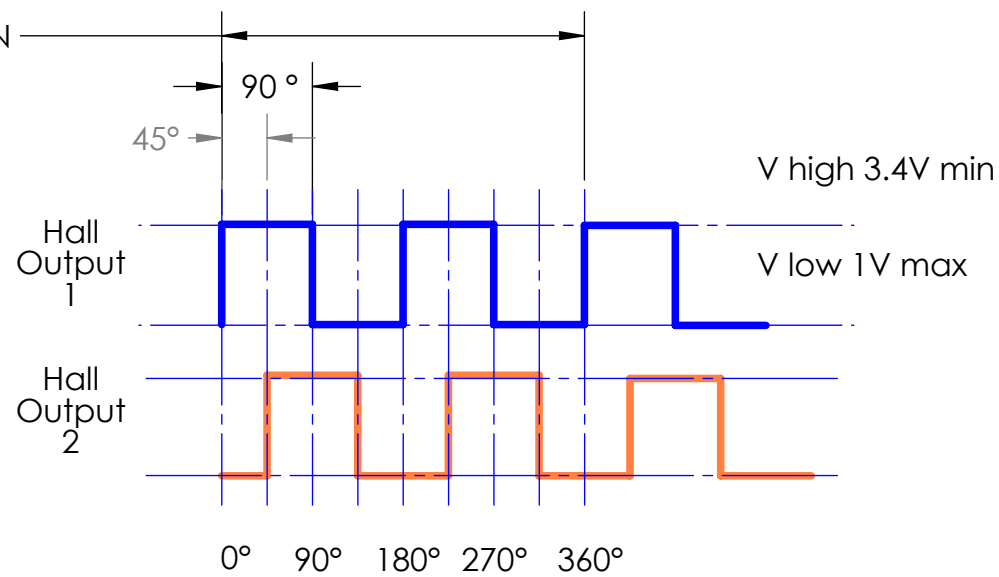

Direction CW if Hall Output 1 rises before Hall Output 2

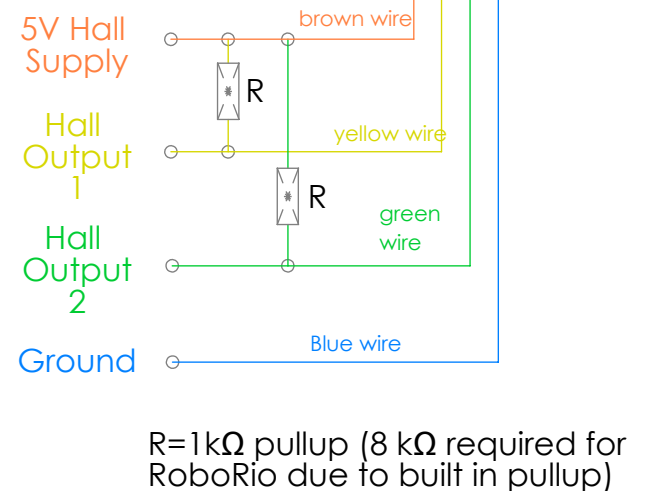

A

Rated Voltage	12V	
Performance with Gear box at RT	N/L speed	310 +/- 37.2 RPM
	N/L current	1.5 A max
	Stall Torque	5.1 +/- 0.8 Nm [3.8 +/- 0.6 ft-lbs]
	Stall current	26A max
General details	Gearbox ratio	22.2:1
	Gearing	Planetary 2 stage
	Weight	200 g [0.44 lbs]

Dimension Format:  
[inches]  
mm

**PROPRIETARY AND CONFIDENTIAL**  
THE INFORMATION CONTAINED IN THIS DRAWING IS THE SOLE PROPERTY OF <INSERT COMPANY NAME HERE>. ANY REPRODUCTION IN PART OR AS A WHOLE WITHOUT THE WRITTEN PERMISSION OF <INSERT COMPANY NAME HERE> IS PROHIBITED.

		UNLESS OTHERWISE SPECIFIED:	NAME	DATE
		DIMENSIONS ARE IN mm[in]	DRAWN	
		TOLERANCES: FRACTIONAL ±	CHECKED	
		ANGULAR: MACH ± BEND ±	ENG APPR.	
		TWO PLACE DECIMAL ±	MFG APPR.	
		THREE PLACE DECIMAL ±	Q.A.	
		INTERPRET GEOMETRIC TOLERANCING PER:	COMMENTS:	
		MATERIAL		
		FINISH		
NEXT ASSY	USED ON			
	APPLICATION	DO NOT SCALE DRAWING		



TITLE:  
**PLG motor for FRC**

SIZE	DWG. NO.	REV
<b>B</b>	<b>JE-PLG-410</b>	<b>1</b>
SCALE: 1:1.5WEIGHT:		SHEET 1 OF 1

4

3

2

1

A